

ETB16 SERIES

WAE133988(R) LR100420



SPECIFICATIONS

- Pitch 5.0 mm, 10.0 mm.
- Wire range 14 AWG to 24 AWG.
- No. of pole per Block 2 or 3
- Rated 10 Amp, 300 VAC
- Housing Polyamide 66, Blue
- Terminals Tin plated over Brass
- Screws M2.6 x 0.45P, Yellow Chromated
- Wire Protector Nickel plated over Beryllium Copper
- Wire cage Nickel plated over Zinc Alloy

ETB16 ** ETB16 ** 1
 Pitch=5.0mm Pitch=10.0mm

ETB16**
Pitch=5.0mm

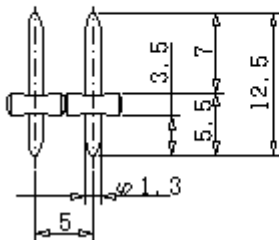
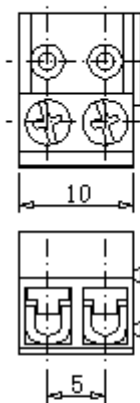

ETB16**1
Pitch=10.0mm

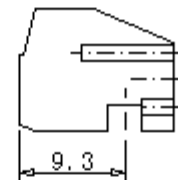
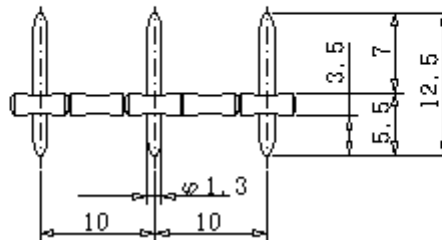
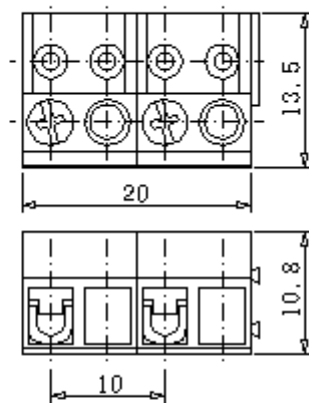

mm to inch

**NUMBER OF POLE 02~30

mm	0.5	0.8	0.9	1	1.3	3	3.5	4.05	4.4	5	5.5	7	9.3
inch	0.02	0.031	0.035	0.039	0.051	0.118	0.138	0.159	0.173	0.197	0.217	0.276	0.366
mm	10	10.8	12.5	13.5	13.8	15.5	18.3	19.1	20	21.9	22.5	25.2	
inch	0.394	0.425	0.492	0.531	0.543	0.61	0.72	0.752	0.787	0.862	0.886	0.992	

ETB18 SERIES

CLAMPING

TÜVR35002918 VDE133988(R)

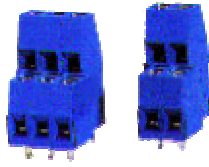

SPECIFICATIONS

- Pitch 5.0 mm, 10.0 mm.
- Wire range 14 AWG to 24 AWG.
- No. of pole per Block 2Px2 or 3Px2
- Rated 10 Amp, 300 VAC
- Housing Polyamide 66, Blue
- Terminals Tin plated over Brass
- Screws M2.6 x 0.45P, Yellow Chromated
- Wire cage Nickel plated over Zinc Alloy

ETB18 ** ETB18 ** 1
 Pitch=5.0mm Pitch=10.0mm

ETB18**
Pitch=5.0mm

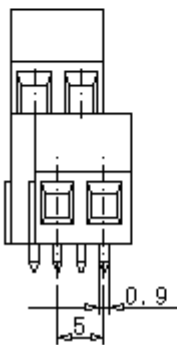
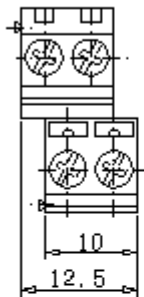

ETB18**1
Pitch=10.0mm

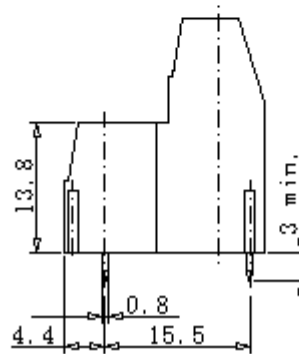
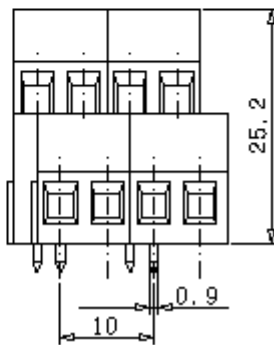
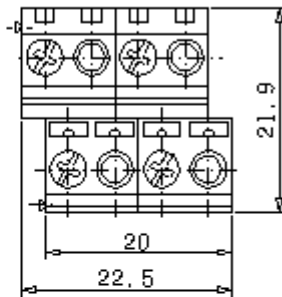

mm to inch

**NUMBER OF POLE 02~30

mm	0.5	0.8	0.9	1	1.3	3	3.5	4.05	4.4	5	5.5	7	9.3
inch	0.02	0.031	0.035	0.039	0.051	0.118	0.138	0.159	0.173	0.197	0.217	0.276	0.366
mm	10	10.8	12.5	13.5	13.8	15.5	18.3	19.1	20	21.9	22.5	25.2	
inch	0.394	0.425	0.492	0.531	0.543	0.61	0.72	0.752	0.787	0.862	0.886	0.992	

ETB19 SERIES

CLAMPING

TÜVR350002918 E133988(R)

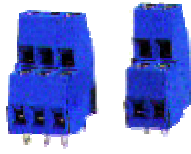

SPECIFICATIONS

- Pitch 5.0 mm, 10.0 mm.
- Wire range 14 AWG to 22 AWG.
- No. of pole per Block 2Px2 or 3Px2
- Rated 10 Amp, 300 VAC
- Housing Polyamide 66, Blue
- Terminals Tin plated over Brass
- Screws M2.5 x 0.45P, Yellow Chromated
- Wire cage Zinc plated over Steel
- Nickel plated over Zinc Alloy

ETB19 ** ETB19 ** 1
 Pitch=5.0mm Pitch=10.0mm

ETB19**
Pitch=5.0mm

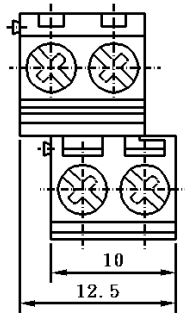

ETB19 1**
Pitch=10.0mm

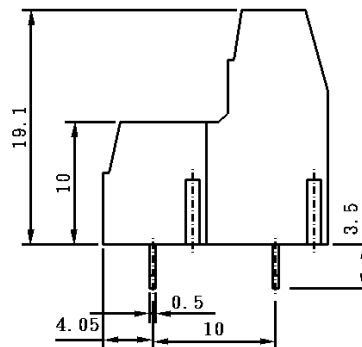
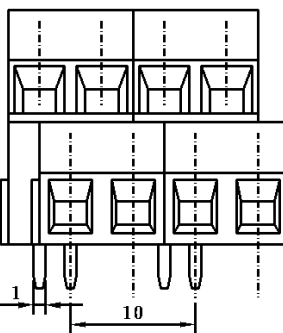
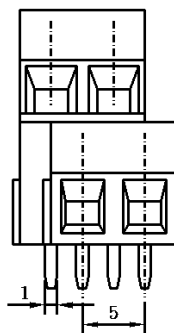
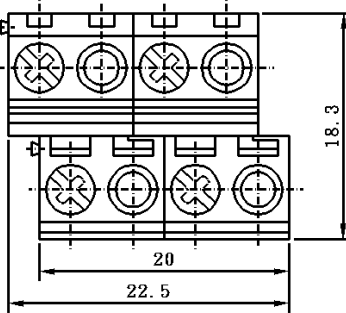

mm to inch

**NUMBER OF POLE 02~30

mm	0.5	0.8	0.9	1	1.3	3	3.5	4.05	4.4	5	5.5	7	9.3
inch	0.02	0.031	0.035	0.039	0.051	0.118	0.138	0.159	0.173	0.197	0.217	0.276	0.366
mm	10	10.8	12.5	13.5	13.8	15.5	18.3	19.1	20	21.9	22.5	25.2	
inch	0.394	0.425	0.492	0.531	0.543	0.61	0.72	0.752	0.787	0.862	0.886	0.992	